

DEMOLITION STAGING PLAN

SCALE: 1" 20'-0"

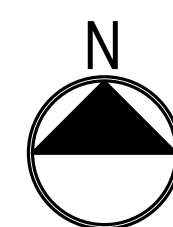
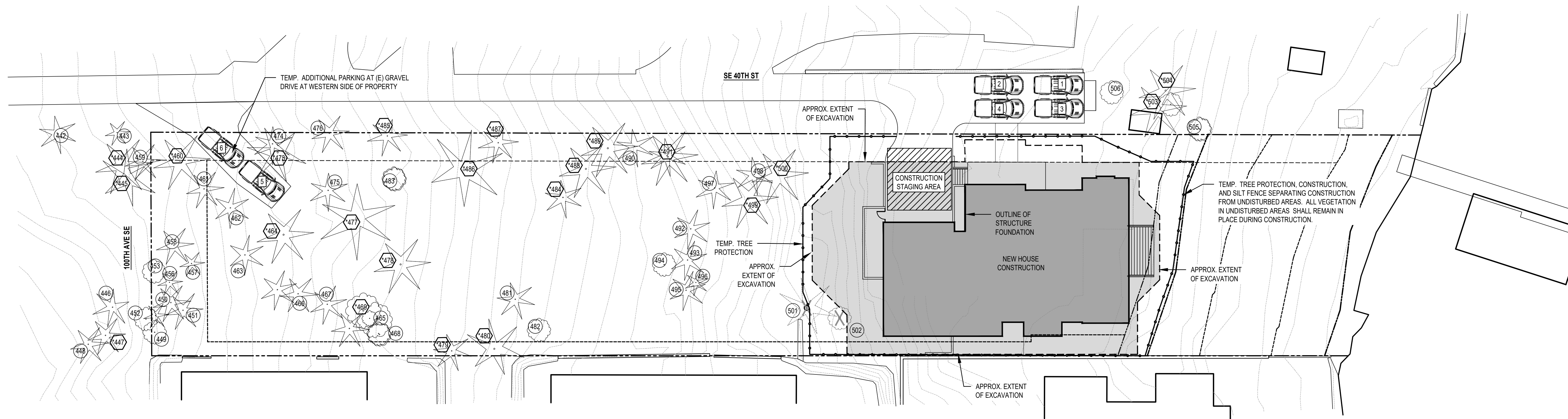

CONSTRUCTION STAGING PLAN

SCALE: 1" 20'-0"

REVISIONS:

PLOT DATE: 11/6/2024
 DRAWN BY: JM
 CHECKED BY: BJS

SHEET
CMP1.0

SCALE: IF SHEET IS LESS THAN 24" x 36" IT IS A REDUCED PRINT, REDUCE SCALE ACCORDINGLY
 PERMIT SET 11/06/2024